

RCT MEGAPOWER

PRODUCT OVERVIEW

The product applies to diversified loads because its digital design, pure sine wave output and excellent overcurrent protection can withstand the loads with a large starting current; the product is provided with independent solar three-stage charge management to improve charge efficiency of its battery and realize a longer life; the product provides universal 5VDC USB output port and 12VDC output to be widely applied to small solar power generation occasions including families, schools, street monitoring, forest monitoring, industrial and mining enterprises, frontier defense, sea islands, pasturing areas, etc.



MAIN FEATURES

- Excellent performance because of an MCU intelligent control technology;
- A wide range of applicable loads because of pure sine wave AC output;
- Convenient and practical 5VDC USB output port and 12VDC output port;
- Solar array and battery common-anode system input;
- Charge by mains supply for flexible configuration (optional function);
- Overcharge protection and overdischarge protection for a longer battery life;
- LCD and LEDS for visualization of operation status of the equipment
- Overall automatic protection and alarms including AC output over load protection, short circuit protection ,etc .

Solar system connection

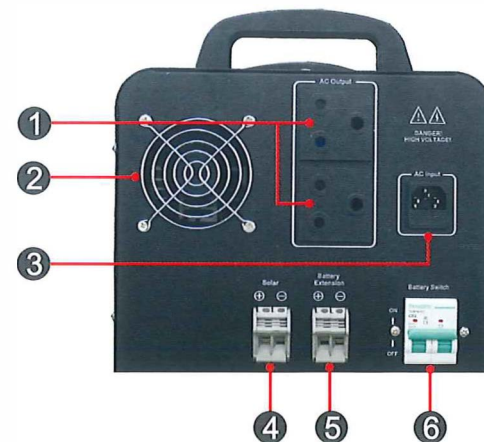
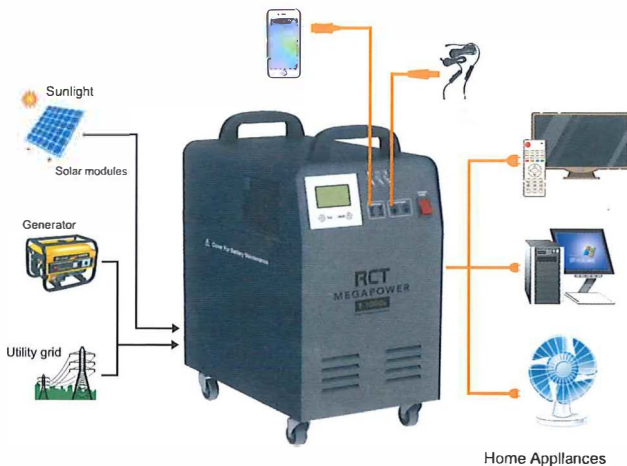

TECHNICAL INDEXES

Model:	T-1000S	T-2000S
Inverter		
Battery voltage	12V	24V
In-built battery specification	100AH/12V	100AH/12V*2
Rated power	1000W	2000W
Output voltage	220VAC	
Output frequency	50/60Hz	
Output waveform	Pure Sine Wave	
Input voltage range	160-275VAC	140-275VAC
Input frequency	45-65Hz	
Solar input		
Maximum photovoltaic voltage(VDC)	≤25V	≤100V
Charge voltage(VDC)	10-25V	30V-100V
Rated charge current(A)	MPPT 30A	MPPT 30A
Maximum power(Wp)	360Wp	800Wp
Voltage of overcharge protection(VDC)	14.2V	28.4V
Voltage of overcharge recovery(VDC)	14.0V	28.0V
Voltage of floating charge(VDC)	13.8V	27.6V
DC output		
Voltage of high-voltage protection(VDC)	16V	32V
Voltage of high voltage recovery(VDC)	15.2V	30.4V
Voltage of low voltage recovery(VDC)	13.0V	26V
Voltage of low voltage protection(VDC)	11.3V	23.2V
5VDC USB output port	2 units/MAX 2A	
12VDC output port	2 DC ports(MAX 2A))	
Starting temperature of the exhaust fan	> 45°C	
Ambient temperature for operation	-20 - +50°C	
Ambient temperature for storage	-25 - +55°C	
Operation/storage conditions	0-90% (no condensation)	
External dimensions: DxWxH (mm)	423 x 260 x 453	439 x 380 x 585
Packing dimension: DxWxH (mm)	520 x 370 x 520	515 x 460 x 632

Product Information

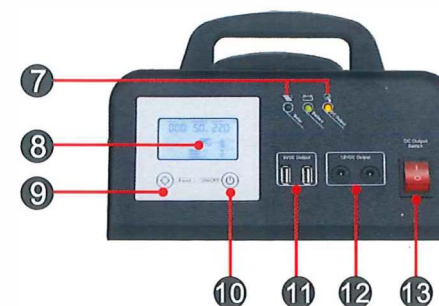

- | | |
|----------------------|----------------------|
| 1. AC Output | 8. LCD Display |
| 2. Smart Cooling Fan | 9. Function Buttons |
| 3. AC Input | 10. ON/OFF Buttons |
| 4. Solar PV Input | 11. 5VDC Output |
| 5. Battery Extension | 12. 12VDC Output |
| 6. Battery Switch | 13. DC Output Switch |
| 7. LED Indicator | |